

Gay Men's Health Crisis, Inc.
The AIDS Service and Education
Foundation
Annual Report
1985

When Gay Men's Health Crisis was founded in August 1981, perhaps no one could have imagined the size and gravity of the spreading epidemic of Acquired Immune Deficiency Syndrome, or AIDS. All that was known was that a group of people, primarily gay men, had developed a rare form of cancer and various opportunistic infections and had died. As of December 31, 1985, over 15,000 cases of AIDS have been reported, and cases continue to double every year.

Gay Men's Health Crisis (GMHC) was the first and, for a long time, the only organization to recognize and confront the emergency of the AIDS epidemic and all of its medical and psychosocial implications. GMHC has taken a leading role in educating health professionals, the general public and populations at high risk in providing extensive patient support services and in raising funds for research on this newly-discovered disease.

On December 10, 1985, GMHC received the Eleanor Roosevelt Community Service Award, which reflects the highest tribute the state can offer to a non-profit organization. This award was in recognition of our outstanding services to the community in confronting the AIDS epidemic. At a ceremony in Albany, GMHC was presented the award by Mathilda Cuomo, Franklin D. Roosevelt, Jr., and Bishop Joseph Sullivan.

We have shown how imagination and determination can be effective in mobilizing a community against a tragic epidemic. GMHC has earned unprecedented respect for the people who built it. But even as funds are raised, as medical advances are made, as government groups are lobbied, we remain true to our original vision: we are a community of concern, a community of caring.

**LETTER FROM THE PRESIDENT,
GMHC, INC.**

GMHC has grown over the last three and one half years in an effort to respond to an ever growing epidemic. From a staff of one and a budget of \$55,000 in our first year of operation, GMHC has expanded to a staff of forty-four with an annual budget in excess of \$2 million.

GMHC has been in the forefront during this period in educating federal officials and legislators on the importance of appropriating funds for medical research, for clinical treatment and drug trials and for education. We have done this by working closely with the AIDS Action Council in Washington, the lobbying arm of AIDS service and education organizations around the country.

GMHC has been the major funding source for the AIDS Action Council and we have made grants to the National Gay and Lesbian Task Force, the Lambda Legal Defense and Education Fund, and the National AIDS Network for their AIDS-Related work.

GMHC has been and will continue to be a major force on the local and national level in the fight against AIDS.



Paul G. Popham, President
Board of Directors
Gay Men's Health Crisis

**LETTER FROM THE EXECUTIVE
DIRECTOR, GMHC, INC.**

1985 was another year of rapid growth and tremendous change for Gay Men's Health Crisis, as we struggled to expand services to those in need, to disseminate information to the public and to promote greater awareness of the importance of medical research.

Since GMHC's founding in 1981, we have grown into the largest AIDS service and education foundation in the world. We have provided financial, legal, counseling and home care services to over 3,000 persons with AIDS and their care partners. GMHC's public information and education programs for the general public, health care professionals and the at risk groups have reached millions of people and saved lives.

Yet the tragedy of AIDS continues. AIDS is now the leading cause of death in New York City for men between the ages of 25 and 49 and for women between the ages of 25 and 29. Hundreds of infants and children have been diagnosed with AIDS and AIDS-related complex and require special care. Perhaps as many as a half-million citizens of New York City are infected with the virus thought to cause AIDS.

AIDS is a problem that will not go away. Every time we look, it looms larger so that the shadow of this disease will darken all our days. The natural human response is to hope that we ourselves will be spared. But as the numbers and kinds of people affected by AIDS grow, it becomes increasingly difficult to maintain the fiction that AIDS is something that happens to "them," not to "us."

The burden of AIDS is not just the burden of death and dying. It is the burden also of contending with fear, hatred and prejudice. It is the burden of caring for the dying and their loved ones. I salute the thousands of New Yorkers - men and women, gay and straight, young and old - who have and will continue to shoulder that burden.



Richard Dunne, Executive Director
Gay Men's Health Crisis



THE VOLUNTEER OFFICE

Since the inception of GMHC, well over 4,000 volunteers have walked through our doors. These men and women bring a special commitment and determination to their work which forms the very backbone of the organization. The bulk of GMHC's services are provided by volunteers. Through their efforts, GMHC was able to provide a wide range of support services to all persons with AIDS and their loved ones.

The Volunteer Office screens and places all incoming volunteers, placing them where the needs of the various GMHC services and the volunteers themselves will be best served. Over 1,700 interviews were conducted in 1985, and many training events took place concerning management, Community Support Network, and front desk coordination.

The office is also responsible for the personnel, administrative and clerical support required by each GMHC program. A well-organized corps of volunteer managers and assistant managers currently supervise over 100 volunteers who work on the duties of this office alone. Volunteers contributed over 17,000 hours to GMHC in 1985.

Another major function is staffing the Community Support Network, a program which distributes donation cans and educational literature to businesses throughout the metropolitan area. The donation cans and the information promote awareness of the AIDS epidemic and of GMHC itself. Last year over \$19,000 was collected, proof that the Community Support Network is a vital fundraising tool.

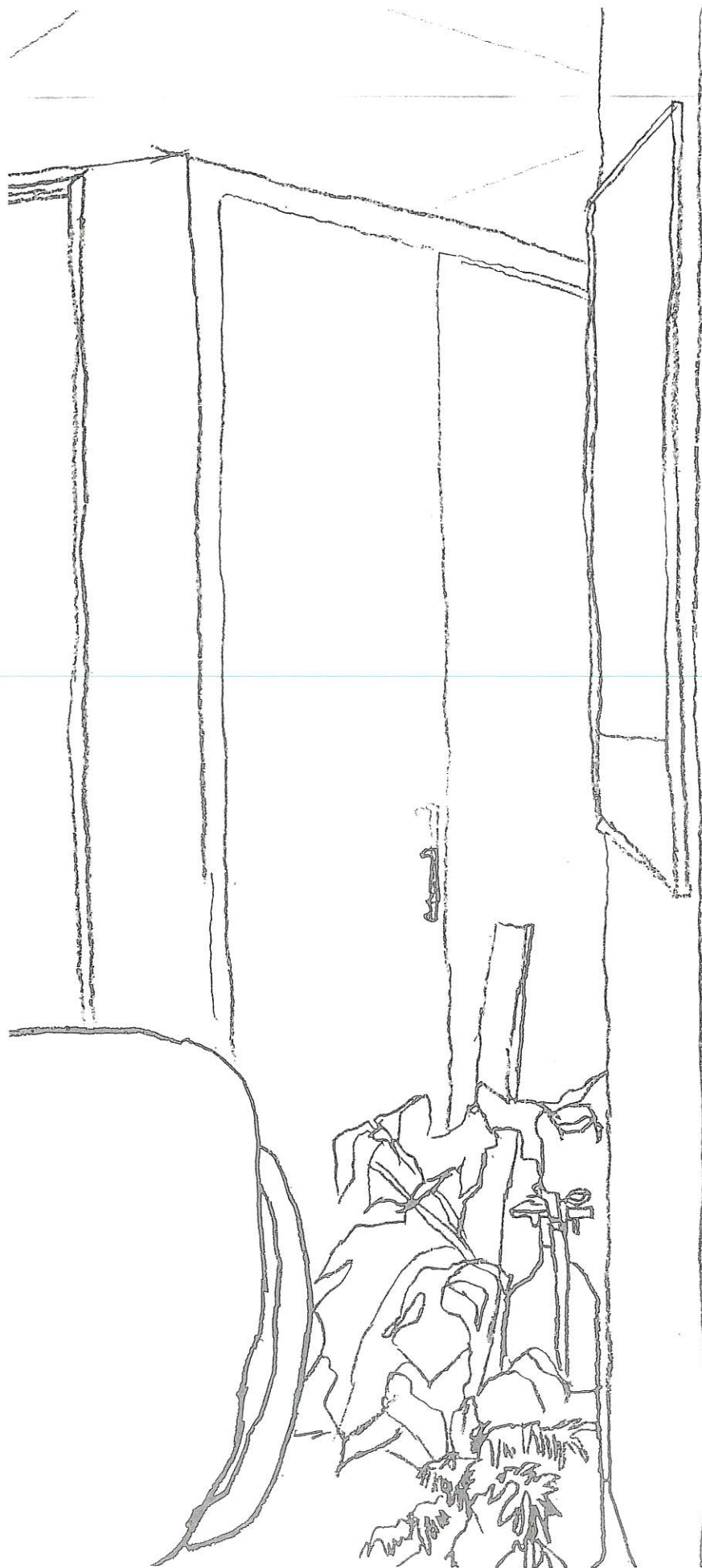

GMHC MEETINGS	
5.16.85	
ROOM 1 ART WORKSHOP	6 ⁰⁰
ROOM 2 AIDS THERAPY GROUP 5	6 ⁰⁰
ROOM 3 AIDS THERAPY GROUP 3 CARE PARTNER'S GROUP	6 ³⁰ 6 ⁰⁰
ROOM 4 AIDS THERAPY GROUP 6	6 ⁰⁰
ROOM 5 AIDS THERAPY GROUP 1 AIDS THERAPY GROUP 4	6 ³⁰ 6 ⁰⁰

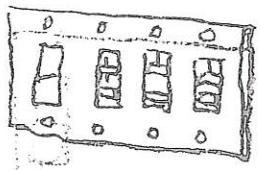

GMHC Reception Room

CLINICAL SERVICES

GMHC volunteers under the supervision of professional staff deliver a large variety of services to persons with AIDS and AIDS-Related Complex (ARC), their lovers, spouses, families, and friends. Services are offered without charge in an atmosphere of warmth, caring and absolute confidentiality.

INTAKE AND REFERRAL PROGRAM

This is where the first contact is made between the people of GMHC and those who need us — not only persons with AIDS, but their families and friends as well.

Once a diagnosis of AIDS or AIDS-Related Complex is established, an appointment is made with a volunteer clinician who will visit the person in the home or in the hospital. The clinician helps determine the client's

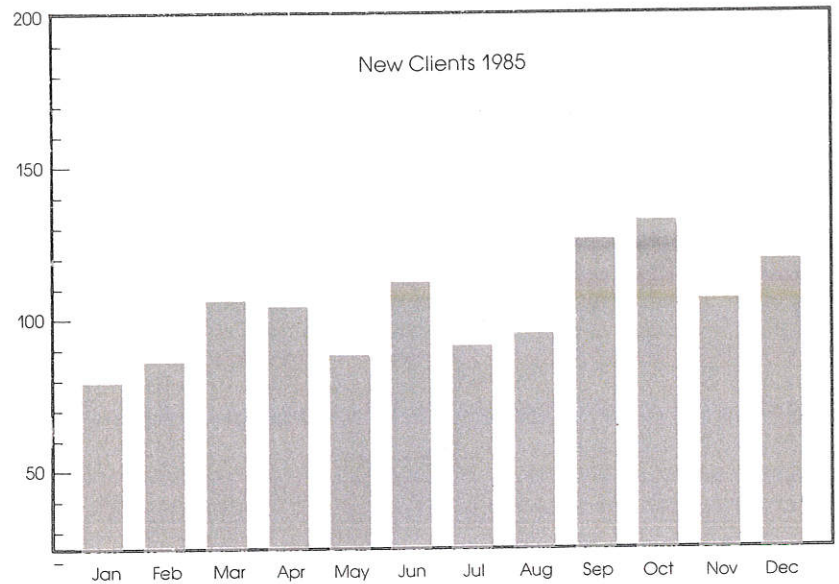

psychological and social needs and makes a referral to one or more of our services. In each case it is essential that the individual feel involved in the decisions affecting his or her future. Friends and family members are offered participation in a Care Partner Group to learn about the disease and how they can cope with their own emotions.

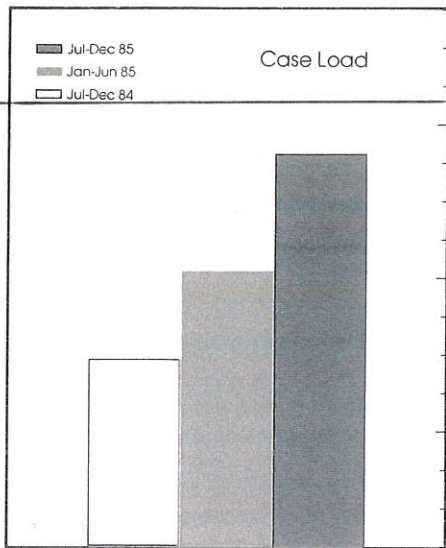

CRISIS INTERVENTION AND BUDDY PROGRAMS

A short-term, six-week crisis intervention counseling service is offered to newly diagnosed persons to help restore their quality of life and prevent future crisis. If a person with AIDS discovers that he or she cannot handle certain daily tasks, such as shopping, cooking and cleaning, a "Buddy" is assigned to help. GMHC's Buddy system has served as a model to similar programs around the country.

The Crisis Intervention Program continued to grow at a remarkable pace in 1985, especially during the latter half of the year. More than 700 new clients were referred during 1985, and the number of volunteers more than doubled.

GMHC now operates crisis intervention units in all five boroughs and some parts of New Jersey. An intensive campaign to recruit



BUDDY SYSTEM

KEVIN AND DAVIS

additional volunteers in the outer boroughs has been planned for 1986, to allow us to extend our services to even more clients.

In 1985, GMHC started a program to reach children with AIDS, ranging from 6 months to 8 years of age. This program is comprised

of volunteers, who visit the children at home or in the hospital and assist the family in receiving social services and home care attendants. Many of the children depend on these volunteers for virtually all of their human contact, since they have been separated from or abandoned by their families.

GROUP SERVICES

Group Services provides a relaxed, informal atmosphere where clients can deal with the social, emotional and behavioral consequences of AIDS. Group therapy sessions serve as a forum for problem solving, help foster supportive social networks and encourage clients to interact with others who are coping with the disease. Care Partner groups provide mutual support for the friends and families of persons with AIDS, and allow them to express their own feelings, problems and needs.

Because referrals to the program grew so rapidly in 1985, additional groups were created, bringing the total number at the end of the year to ten therapy groups and eleven Care Partner groups. In addition, there are weekly "walk-in" support groups for people with AIDS or ARC and their care partners. We also developed a group for parents whose grown children have AIDS, one for the parents of young children with AIDS, and a group for couples who are coping with the impact this disease has on their lives.

Recruitment of trained mental health professionals continued to be a priority in 1985. By year's end our volunteer staff included 32 group leaders under the direction of a salaried clinical supervisor.

As a result of an increasing caseload and expanding programs, it has become more and more important to find additional space to accommodate those who need our help.

THE OMBUDSMAN UNIT

The office of the Ombudsman, which was created in 1985, provides advocacy services to those who are having problems within the health care delivery system. All complaints are investigated to determine their validity, and are followed through to a satisfactory resolution for the client. The office has developed relationships with outside agencies and institutions to ensure prompt quality service for persons with AIDS and to encourage new resources and services.

Problem areas documented to date include hospital and home care, dentistry, dialysis treatment, care in prisons and mental health institutions, ambulance service and funeral homes. Such problems are dealt with through state regulatory agencies, hospital associations and the New York State AIDS Institute. The Ombudsman also monitors the efforts of various GMHC services to provide the best care for our clients.

SUPPORT GROUP AN ENORMOUS SOURCE OF INSPIRATION



RECREATION THERAPY SERVICES

Recreation therapy continues to be an essential component of the services that GMHC offers. The purpose of this program is to promote leisure as a vital component of each client's quality of life and to reduce the isolation that persons with AIDS so frequently feel. We offer them a supportive, non-threatening, nurturing environment and the opportunity to find, develop, and maintain social support networks.

There were over 300 events and activities last year, including workshops in acting, writing, relaxation and crafts; gallery and museum tours; and special holiday and seasonal events. Support from concerned individuals and community groups also increased last year, allowing clients to renew and maintain ties with all the city's rich cultural resources. A Recreation Telephone Team was organized and staffed by persons with AIDS to maintain contact with other clients, many of them homebound or hospitalized.

FINANCIAL ADVOCACY

The importance of this service is reflected in its rapid growth, more than doubling its active caseload in 1985. (In addition, GMHC receives many calls from persons all over the country seeking advice on public entitlement programs.)

The role of the GMHC Financial Advocacy Office is to assist all persons with AIDS or ARC in filing for public entitlements such as New York State Disability, Supplemental Security Income, Social Security Disability or New York City Welfare. Our staff and volunteers provide clients with vital and on-going assistance in obtaining the maximum benefits available through federal, state, and city agencies. The processing of all applications for our clients is done by financial volunteers either while the client is in hospital or in the client's home (if he or she is non-ambulatory) or at a regularly scheduled clinic held at the GMHC office. In addition, the department constantly monitors these entitlements and, if appropriate, advocates for constructive change in filing procedures so that the clients can receive the benefits in the most efficient manner.

With the dramatic growth of new cases, the number of crises have also increased, stressing the significance of the Emergency Grant Program. This program, to keep up with the cost of living, has increased its maximum grant from \$200 to \$400 for the desperately needy.

GMHC/FIBERCRAFT CLASS



LEGAL SERVICES

GMHC's Legal Services Department extends valuable help in writing wills and powers of attorney, and in dealing with insurance problems, discrimination and conflicts with landlords and creditors.

Our 1985 caseload numbered 546 clients, with another 857 projected for 1986. To meet this incredible demand, the department has been:

1. Expanding our volunteer staff through outreach to various legal agencies, firms and bar associations.
2. Delivering services not only to a greater number of clients but also to a more diverse clientele, dealing with such issues as child custody and divorce.
3. Expanding our legal library.

Wills are provided free of charge to those persons with AIDS who have less than \$5,000 in assets and earn under \$20,000 a year. Others are referred to the Bar Association for Human Rights, an organization of gay and lesbian attorneys, for a private, paid consultation.

A significantly growing number of persons with AIDS, as well as those suspected of having the disease, are being asked to take the HTLV-III antibody test by health and life insurance companies. Therefore, insurance problems have become a high priority among the department's responsibilities.

Because AIDS became highly publicized without the accompanying education, the number of discrimination cases has also increased significantly. In employment, housing, public accommodation and health care facilities, persons with AIDS, as well as those perceived to have AIDS, are being discriminated against in a variety of ways. Responding to these needs has also become one of the fastest-growing areas of practice for the department.

PUBLIC INFORMATION DEPARTMENT

Within a few short years, GMHC's Public Information Department has become a major resource for many journalists. During the last year, millions of Americans, and people around the world, came to view GMHC, our programs, clients, staff and volunteers — indeed, the entire gay community — more positively than ever in our history. The time and energy the Department has devoted to developing and maintaining press contacts, and working to ensure that AIDS stories are reported accurately and sensitively, has proven to be a great source of strength for GMHC and our clients.

In May 1985, the New York Times Magazine featured a major story involving a crisis intervention worker and his client. The story, an extremely moving account of the developing relationship between the two men, inspired a great deal of interest in both the press and general public. There was an immediate increase in donations of time and money after the article appeared. GMHC also used reprints as part of a direct mail campaign to solicit contributions and recruit new volunteers.



EDUCATION

With one-third of the total number of AIDS cases diagnosed in New York City, and the number of cases reported in the city twice that of a year ago, the demand for educational services increased dramatically during 1985. Events that could not be foreseen, however, impacted with such force on the Department's resources that the high quality of educational services provided in the past simply could not be maintained.

Request for services routinely delivered by the Education Department increased beyond the capacity of the Department to deliver. Nevertheless, toward the end of the year we were able to provide twice the number of speakers that had been requested during the same period in 1984, and we were sending out approximately 10,000 pieces of literature each month. We have emerged from the experience with a departmental model for 1986 that will leave us less vulnerable and more flexible in responding to the fluctuating public demands for educational services.

The Department invested heavily in time, talent and energy to obtain the financial resources necessary to expand its services, and for research into the modification of sexual behavior through education. The New York State AIDS Institute partially funded a

1985 project to identify the methodology and materials most effective in leading gay men from high risk to low risk sexual practices. Simultaneously, a research proposal on the prevention of transmission of the HTLV-III virus was prepared and submitted to the Centers for Disease Control. It is hoped that funding for this two year study will be provided in 1986.

Other contracts were negotiated and research undertaken that will influence the direction of our efforts in 1986 and beyond. One agreement with the New York City Department of Health provides funding for publication of "Medical Answers About AIDS," a GMHC publication written by Lawrence Mass, M.D. Another provides funds for an AIDS Information and Education Project that will run from November, 1985 through June, 1986.

Increasing demands for services, improved financial support, new information about the way sexual behavior can be modified, and a substantial investment in on-going risk-reduction, all combine to define the educational function of GMHC during the next few years. Until biomedical studies reveal a therapy for the treatment and prevention of AIDS, education remains the single most viable means by which the disease and its consequences can be curtailed.

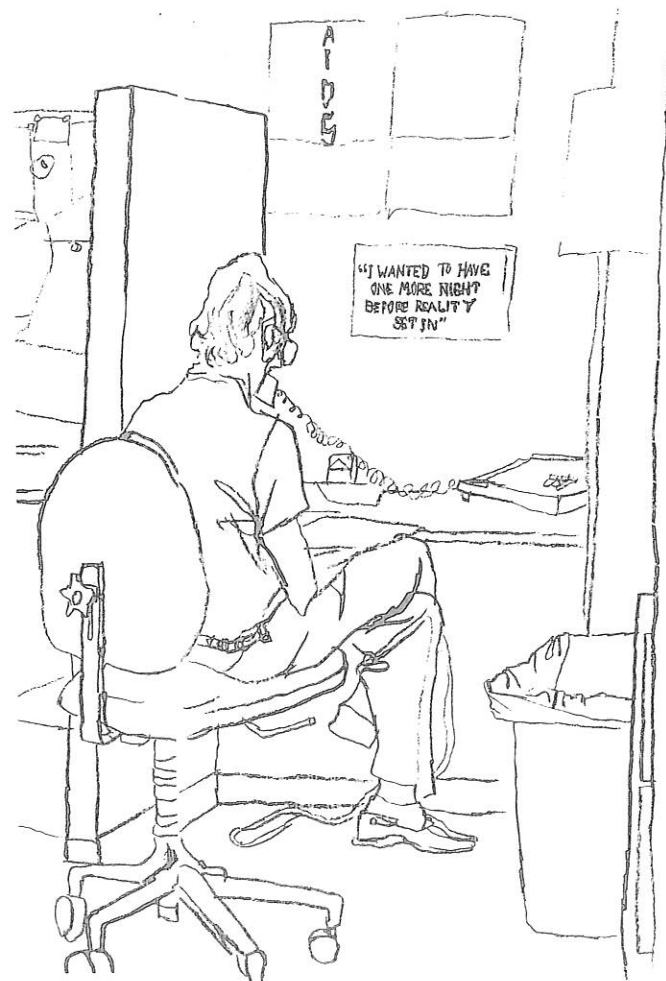

GMHC
Hot Line
All Volunteer workers
People concerned about
Symptoms, etc. Referrals
People who are newly
diagnosed and sending
them to appropriate places
Information Clearing Center
All Cases international

OUTREACH SERVICES

Formerly the Community Information Division, GMHC's Outreach Services, a component of the Education Department, is the organization's first response to inquiries from the gay community and general public about AIDS.

The division was initially developed as a telephone hotline to handle individual and immediate requests for information. As the volume of telephone calls increased, however, a number of outreach tables were established throughout the community to provide literature and on-the-spot answers for the general public. While there are more than 90 volunteers currently manning the phones and information tables, we still find our efforts are being hampered by the inaccessibility of more office space.

The GMHC Hotline, which receives over 6,000 calls a month operates each weekday



from 10:30 am to 9 pm, and from noon to 3 pm on Saturdays. Sunday calls are received via an answering service and are returned as soon as possible. An emergency beeper system is always in use.

Community Outreach is available to most private or public groups that request our presence and literature. We have appeared at street fairs, community functions and on street corners in all five boroughs through-

out the year. Permanent indoor locations have been established at various bars and clubs and in many of the city's major health facilities.

All Outreach Services volunteers undergo monthly training sessions to keep abreast of medical and research developments, changes in public health policies and procedures and new programs within GMHC.

Christopher Se E

GMHC, acting for signatures from
nyc people, for more funding
from the government
Memorial Day weekend
5/25/85

AIDS UPDATE	
CASES REPORTED	
NYC	3,489
NATIONWIDE	10,415
DEATHS	
NYC	1,703
NATIONWIDE	5,000

GAY MEN'S HEALTH

IS, INC.

Wall Street - N.Y.C.



FUNDING

Gay Men's Health Crisis expanded its income significantly in 1985, enabling the agency to meet much of the demand for its services. In 1985, total income was \$2.1 million, an increase of 167% over 1984.

Contributed income constituted 82.4% of the agency's income, totalling \$1.7 million. The largest portion of this amount was raised through benefit events, which has been the greatest source of revenue for GMHC since its founding.

In 1985, GMHC held the most successful fundraising event ever held by and AIDS-Related organization, the GMHC Art Auction at Sotheby's on November 20. Over 250 works of contemporary art were donated by artists, galleries and collectors, and 700 people attended. Net proceeds for the event totalled \$920,000, which also made this one of the most successful benefit art auctions ever held in New York. Nathan Kolodner, Director of the André Emmerich Gallery, was the Benefit Chairman, and the Honorary Benefit Committee included 38 prominent gallery owners and art dealers.

On November 3, Actors' Equity Association and 23 other performing arts groups sponsored "The Best of the Best," a benefit performance at the Metropolitan Opera House at Lincoln Center. The star-studded show was produced by Fritz Holt and Barry

Brown, with Lauren Bacall and Stephen Sondheim acting as the Honorary Chairpersons. Proceeds were divided between GMHC and two other AIDS-Related organizations; net proceeds to GMHC totalled \$295,000.

The general individual contributions, largely unsolicited, from people who are familiar with GMHC, are a continuing testament of concern for those whom we serve and an affirmation of the importance of our work. GMHC received hundreds of general contributions each month, including \$71,000 through a direct mail campaign.

Memorial Fund donations also increased substantially. Many people find contributions to GMHC to be a particularly fitting way to honor a loved one who has died. During 1985, contributions were received in memory of 187 individuals, totalling \$75,000.

In December, 1985, Chemical Bank announced GMHC's first major corporate grant, \$7,500 for a publication on Women and AIDS. There was also encouraging corporate support through advertising pages in the program of "The Best of the Best."

Public support in 1985 totalled \$370,000, including grants from the New York State Department of Health, the New York City Department of Health, and the New York City Human Resources Administration. No funding was received from the federal government.

STAFF

Administration

Richard D. Dunne
Executive Director

Sandi Feinblum
Deputy Executive Director for Management

Barry Davidson
Facilities/Personnel Manager

Paul Russel Carro
Controller/Contract Manager

Terence Kiernan
Office Manager

Michael Moran
Word/Data Processor

Dennis Thaw
Bookkeeper

Peter Heslin
Bookkeeper

Carole Lemens
Administrative Assistant

Volunteer Office

John Campanella
Manager

Michael Brown
Assistant Manager

Kevin Madden
Assistant Manager

Rick Croll
Administrative Assistant

William Di Tucci
Receptionist Days

William Scott
Receptionist Evenings

Clinical Services
Diego Lopez, C.S.W.
Director

Patrick Hacker
Intake Coordinator

Daniel Korté
Intake Assistant Coordinator

Vin Longo
Clinical Services Specialist

Jeff Natter
Clinical Services Specialist

John Martich
Group/Recreation Coordinator

Richard Wein, Ph.D.
Group Supervisor

Steve Gruber
Clinical Services Specialist

Financial - Funding

Benefits

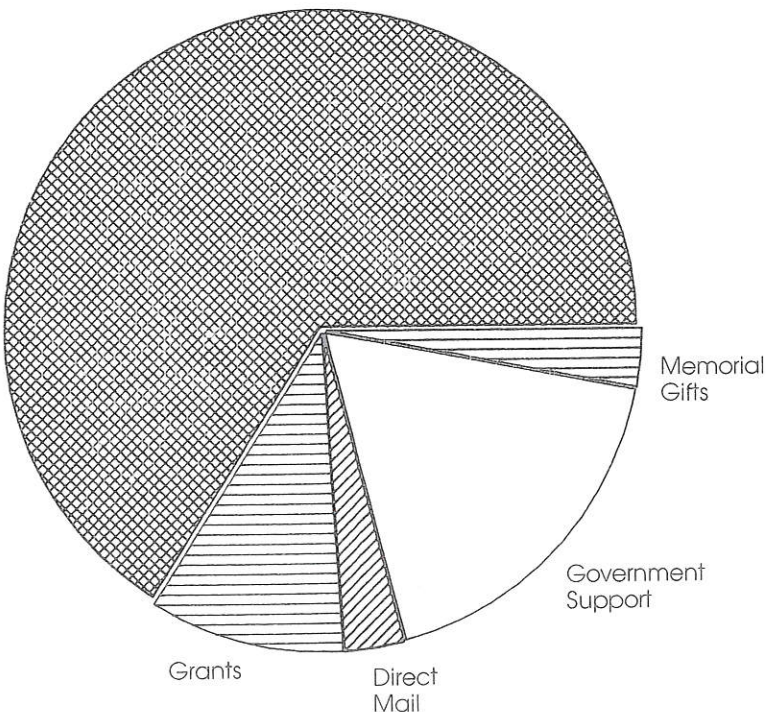

Robert Cecchi
Ombudsman

Paul Zakrzewski
Recreation Supervisor

Audrey Hassell
Financial Advocacy Coordinator

Robert Bolton
Financial Advocate

Donna Dash
Benefit Specialist

Anthony Sbordoni
Benefit Specialist

Thomas J. Jefferson
Financial Advocate

Legal Services

Mark Senak, Esq.
Director

John Mokricky
Legal Services Specialist

Public Information

Lori Behrman
Director

Education

Charles McKinney, Ed. D.
Director

Robert Lugo
Information Services Coordinator

Raymond Jacobs, TRS, RDT
AIDS Prevention Coordinator

James M. Holmes
AIDS Prevention Administrative Associate

Joey Leonte III
Publications Coordinator

David Dixon
Audio-Video Technician

Jerry Johnson
Outreach Services Coordinator

Bruce Woods Patterson
Outreach Assistant

Kevin Mahony
Administrative Assistant

Rodger McFarlane
*AIDS Professional Education Program
Director*

Susan Richardson
*AIDS Professional Education Program
Coordinator*

Development

William D. Jones
Director

THE TREASURER'S REPORT

Income in excess of two million dollars was received by Gay Men's Health Crisis during the fiscal year 1985, which more than doubled last year's revenues. Contributions, fund raising benefits, memorial fund contributions, bequests and foundation grants contributed about 75% of this total, with state and city grants providing the balance.

Whereas our income exceeded expectations I am most gratified to report that operating expenses once again fell well within budget. Thus your organization continues to follow a path of fiscal responsibility and financial health, as evidenced by a substantial increase in the GMHC Endowment Fund.

GMHC anticipates acquiring and renovating client service and office space in 1986. We have out grown our present facilities and new space is urgently needed. This surely represents the greatest financial challenge your organization has ever had to face. With your continuing financial support, we shall be equal to the task ahead.



Joe Paschek
Treasurer

Expenses - 1985

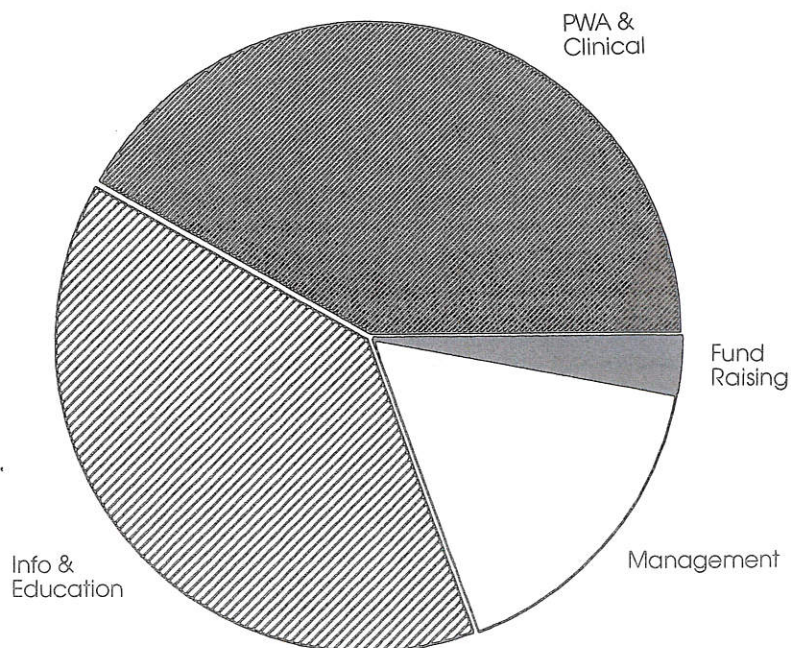

Joseph R Concilio

Certified Public Accountant

236 West 26th Street Suite 7SW New York New York 10001 212 924-3838

BOARD OF DIRECTORS
GAY MEN'S HEALTH CRISIS, INC.
NEW YORK, NEW YORK

I have examined the Statement of Assets, Liabilities and Fund Balances arising from the cash transactions for Gay Men's Health Crisis, Inc. at December 31, 1985, and the related Statements of Public Support, Revenue Received and Expenses and Changes in Fund Balances for the year then ended. My examination was made in accordance with generally accepted auditing standards, and accordingly included such tests of the accounting records, and such other auditing procedures as I considered necessary in the circumstances.

In my opinion, the accompanying Statements present fairly the Assets, Liabilities and Fund Balances of Gay Men's Health Crisis, Inc. at December 31, 1985, arising from cash transactions, and the Public Support, Revenue Received and Expenses and Changes in Fund Balances during the year then ended, on a basis consistent with that of the preceding year.

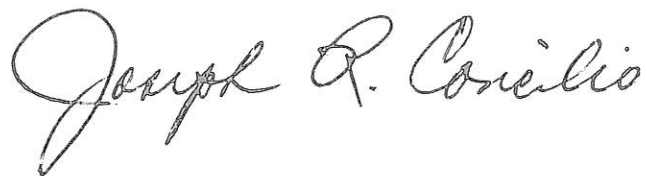
A handwritten signature in cursive script that reads "Joseph R. Concilio". The signature is written in dark ink and is positioned above the printed name.

Joseph R. Concilio

New York, New York

Statement of public support,
revenue received and expenses
and changes in fund balance
Gay Men's Health Crisis, Inc.
Year ended December 31, 1985

	<u>Restricted Fund</u>	<u>Unrestricted Fund</u>	<u>Total All Funds</u>
PUBLIC SUPPORT AND REVENUE RECEIVED			
Public Support			
Contributions	\$ 41,546	\$ 253,912	\$ 295,458
Newsletter Solicitation	-0-	17,203	17,203
Coinbox Solicitation	-0-	19,253	19,253
Established Memorial Funds	-0-	83,315	83,315
Outside Benefits & Grants	-0-	440,746	440,746
Special Events, Net of Direct Costs of \$59,983	-0-	883,834	883,834
Government Grants	<u>326,624</u>	<u>-0-</u>	<u>326,624</u>
Total Public Support	\$ 368,170	\$ 1,698,263	\$ 2,066,433
Revenue Received			
Investment Income	-0-	31,373	31,373
Total Revenue Received	<u>-0-</u>	<u>31,373</u>	<u>31,373</u>
TOTAL PUBLIC SUPPORT AND REVENUE RECEIVED	<u>368,170</u>	<u>1,729,636</u>	<u>2,097,806</u>
EXPENSES			
Program Services			
Persons with AIDS and Clinical Services	210,648	261,930	472,578
Public Information and Education	<u>138,389</u>	<u>300,441</u>	<u>438,830</u>
Total Program Services	<u>349,037</u>	<u>562,371</u>	<u>911,408</u>
Supporting Services			
Management and General	-0-	186,389	186,389
Total Supporting Services	<u>-0-</u>	<u>186,389</u>	<u>186,389</u>
Fundraising			
Total Fundraising	<u>-0-</u>	<u>33,822</u>	<u>33,822</u>
TOTAL EXPENSES	<u>349,037</u>	<u>782,582</u>	<u>1,131,619</u>
EXCESS OF PUBLIC SUPPORT AND REVENUE RECEIVED OVER EXPENSES	<u>19,133</u>	<u>947,054</u>	<u>966,187</u>
Fund Balance as of January 1, 1985	59,749	515,020	574,769
Reclassification of Endowment Fund	(51,000)	51,000	-0-
FUND BALANCE AS OF DECEMBER 31, 1985	<u>\$ 27,882</u>	<u>\$ 1,513,074</u>	<u>\$ 1,540,956</u>

Statement of functional expenses
Gay Men's Health Crisis, Inc.
Year Ended December 31, 1985

	Program Services		Supporting Services		Total Expenditures
	Persons with AIDS and Clinical Services	Public Information and Education	Management and General	Fundraising	
Staff Compensation	\$ 251,212	\$ 135,498	\$ 120,340	\$ 17,926	\$ 524,976
Employee Health Benefits	13,391	7,253	6,417	837	27,898
Payroll Taxes	20,499	11,104	9,822	1,281	42,706
Professional Fees	1,584	858	759	99	3,300
Supplies & Stationary	9,337	23,102	7,854	2,672	42,965
Telephone	16,951	12,765	2,497	326	32,539
Postage & Shipping	8,073	12,857	2,024	3,387	26,341
Occupancy	42,465	5,262	6,841	1,052	55,620
Printing & Publications	13,280	73,347	1,743	207	88,577
Travel	9,808	11,100	1,805	235	22,948
Advertising	6,198	3,357	2,970	387	12,912
Grants & Allocations	23,016	-0-	-0-	-0-	23,016
Hotline Expenses	-0-	12,044	-0-	-0-	12,044
Volunteer Training & Related Costs	9,941	-0-	-0-	-0-	9,941
Clinical Service Expenses	753	-0-	-0-	-0-	753
Direct Financial Aid & Recreational Activities - Persons with AIDS	14,444	-0-	-0-	-0-	14,444
Direct Education & Informational Expenses	-0-	72,924	-0-	-0-	72,924
Public Forum & Expenses	-0-	18,712	-0-	-0-	18,712
Consultants	4,543	22,227	3,194	-0-	29,964
Miscellaneous	11,571	8,018	12,690	4,443	36,722
TOTAL EXPENSES BEFORE DEPRECIATION	457,066	430,428	178,956	32,852	1,099,302
Depreciation	15,512	8,402	7,433	970	32,317
TOTAL FUNCTIONAL EXPENSES	\$ 472,578	\$ 438,830	\$ 186,389	\$ 33,822	\$ 1,131,619

Notes to financial statements
Gay Men's Health Crisis, Inc.

Note A: Organization

Gay Men's Health Crisis, Inc. ("GMHC"), was incorporated under New York State law on June 25, 1982, and created for the purpose of advancing the scientific and public knowledge and treatment of diseases associated with defects in the body's immune system affecting the gay community, including support for medical research aimed at curing and treating such diseases, support for clinical programs for the medical and psychological treatment of persons affected with such diseases, and providing information to the public about such diseases and their treatment.

Note B: Summary of significant accounting policies

The financial statements have been prepared in accordance with the American Institute of Certified Public Accountants' industry audit guide, "Audits of Voluntary Health and Welfare Organizations."

Note C: Financial commitments

During 1984, GMHC entered into a lease for premises with minimum annual rental commitment under said operating lease of:

1984 - 89	\$174,000
1989 - 94	204,000
1994 - 99	<u>252,000</u>
1984 - 99	<u>630,000</u>

Note D: Donated services

No amounts have been reflected in the statements for donated services inasmuch as no objective basis is available to measure the value of such services; however, a substantial number of volunteers have donated significant amounts of their time in the organization's program services.

Note E: Tax exempt status

GMHC has obtained a ruling from the Internal Revenue Service which states that it has qualified to operate as a publicly supported organization as defined by the Internal Revenue Code, and is exempt from taxation under section 501(c)(3) of the code.

BOARD OF DIRECTORS

President

Paul Popham
McGraw-Hill, Inc.

First Vice-President

Dan Bailey
Teacher

Second Vice-President and Secretary

Frank Lilly, Ph.D.
Albert Einstein College of Medicine

Treasurer

Joachim Paschek
Sterling Sound

Chairperson, Directorship Committee

The Honorable Richard C. Failla
Criminal Court of the City of New York

Chairperson, Government Relations Committee

Leonard H. Bloom, Esq.

Chairperson, Fundraising and Public Relations Committee

Ira M. Berger
New York Law School

Nick Bollman

Community Council of Greater New York

Robert Cecchi

GMHC Volunteer

Robert M.T. Diario

Psychological and Business Management Consultant

Claudette Lefebvre, Ph.D.

New York University

Lawrence McDevitt

New York City Department of Health

Russell A. Radley

Metropolitan Management Associates

Rafael Tavares, M.D.

Columbia Presbyterian Medical Center

Elected April 23, 1986

President

Ira M. Berger
New York Law School

First Vice-President

Frank Lilly, Ph.D.
Albert Einstein College of Medicine

Second Vice-President and Secretary

Claudette Lefebvre, Ph.D.
New York University

Treasurer

Bernard L. See
National Westminster Bank

Leonard H. Bloom, Esq.

Nick Bollman

Community Council of Greater New York

Robert M.T. Diario

Psychological and Business Management Consultant

The Honorable Richard C. Failla

Criminal Court of the City of New York

Ronald Johnson

University Settlement Society of New York

Nathan Kolodner

André Emmerich Gallery, Inc.

Kenneth Meeks, Ph.D.

Max Navarre

James G. Pepper

Brundage, Story and Rose

Rafael Tavares, M.D.

Columbia Presbyterian Medical Center

HONORARY DIRECTORS

Founding President

Paul Popham

Dan Bailey

Joachim Paschek

Affiliations are listed for identification purposes only

Illustrations by John Ruggieri
Text by Frank Decker
Charts by Michael Callery
Coordinated by Michael Moran

